

CFS 70/100 WATT GARAGE LIGHTER

Available in lamp color temperatures 5000K.

Part Number:

70 Watt: CFS-KGL/70

100 Watt: CFS-KGL/100

FEATURES: Injection molded clear prismatic polycarbonate diffuser.

ELECTRICAL: UL listed for wet locations for ceiling mount and damp locations. 70/100 Watt, 120 through 277 VAC.

HOUSING: Die cast aluminum. A neoprene gasket eliminates moisture, dust and insects.

DIFFUSER: Clear prismatic polycarbonate with UV inhibitors to minimize discoloration.

MOUNTING: Ceiling mount for indoor or outdoor application.



Induction lighting Features

No electrodes or filaments

- *100,000 hrs rated average life.
- *Low lumen depreciation of <30% @ 60,000 hours.
- *Low operating temperature of components.

High-frequency operation

- *High system efficacy(65-70lm/W)
- *No flickering
- *No stroboscopic effect
- *No noise

Electronic control

- *Output-protected HF generator

Instant (re-)start

- *Light available instantly when needed
- *Short ignition time <0.5sec

3-line fluorescent coating

- *Choice of color temperature
- *White light
- *Excellent color rendition (CRI 85)
- *No color deviation

Induction Lighting Benefits

- *High reliability and virtually maintenance-free operation.
- *Lasting light output right through life time.
- *Increased safety, more standard luminaire construction.
- *Economic, environment-friendly lighting in situations with long burning hours.
- *Restful non-fatiguing light.
- *No danger with rotating machinery.
- *Non-disturbing in operations.
- *Automatic switch-off in case of lamp or power coupler failure.
- *Generator resets 15-30 seconds after switch off.
- *Suitable for security and safety lighting.
- *More comfort.
- *Useful light immediately after switch-on.
- *Installation can be matched to lighting situations and requirements.
- *Uniform predictable lighting results throughout larger installations; color maintained through life.

INDUCTION LIGHTING

Induction lighting makes use of a technology which is fundamentally different from that of incandescent lamps or today's conventional gas discharge lamps. Instead of the glowing filaments of incandescent lamps, or the electrodes used in conventional gas discharge lamps, light generation is by means of induction— the transmission of energy via a magnetic field— combined with a gas discharge. Combining the basic principles of induction and gas discharge, this revolutionary concept in light generation offers benefits never before possible.

All CFS Inc. products come with a 5 year warranty.

CFS INC.

3 Adams Street- Belvidere, NJ 07823- Tel: 908-475-8991 Fax: 973-729-1271

E-mail: info@cfsinc.us

Web Site: www.cfsinc.us

PHOTOMETRICS FOR 100 WATT GARAGE LIGHTER

LUMINAIRE:
 CAST ALUMINUM HOUSING, FORMED
 WHITE ENAMEL ALUMINUM STEEL RE-
 FLECTOR, CLEAR PRISMATIC EN-
 CLOSURE.

LAMP:
 ONE VBU 100 WATT INDUCTION LAMP
 RATED AT 7,500 LUMENS.

HIGH FREQUENCY GENERATOR:
 92.92 WATTS, 120~277VAC, 0.7754A,

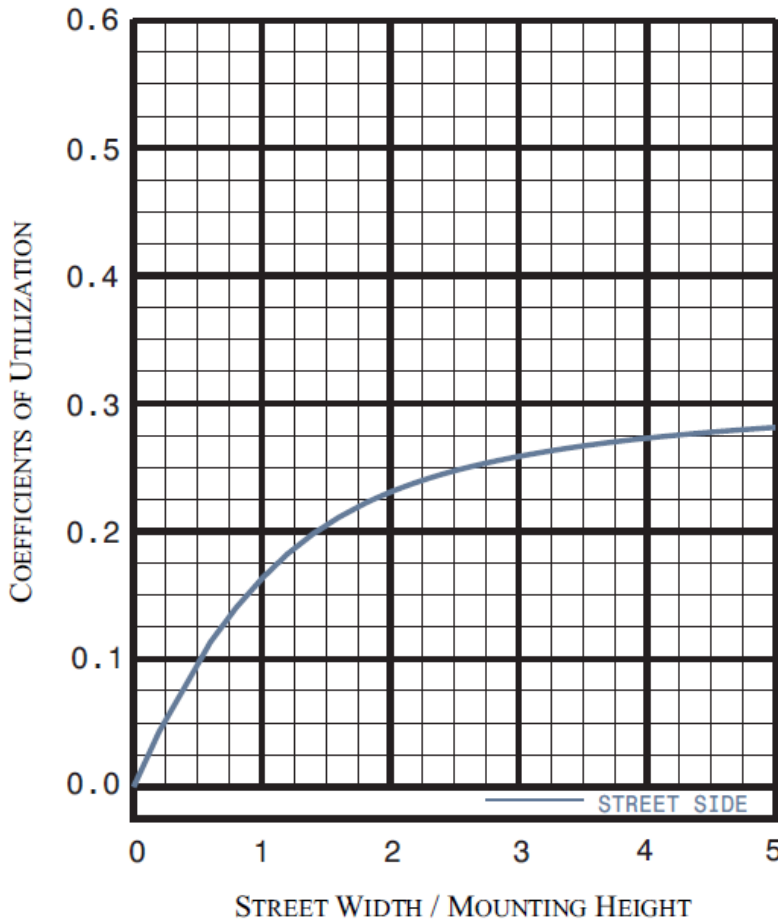
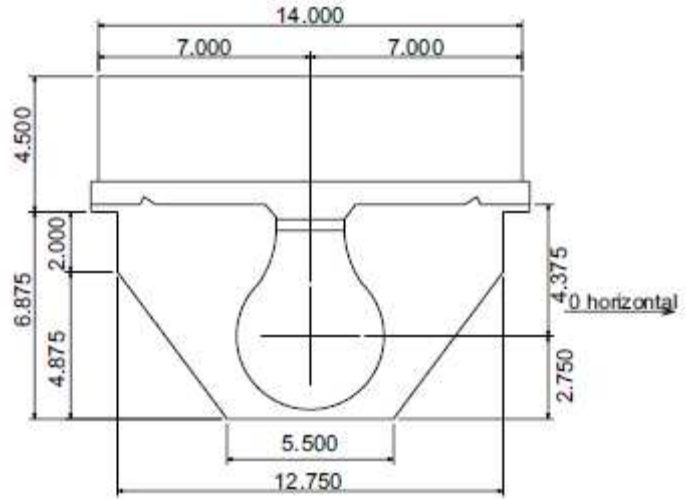

IES CLASSIFICATION: **TYPE V**
 CUTOFF CLASSIFICATION: **NON-CUTOFF**

FLUX DISTRIBUTION

LUMENS	DOWNWARD	UPWARD	TOTALS
HOUSE SIDE	2340.69 (31.2%)	640.55 (8.5%)	2981.24 (39.7%)
STREET SIDE	2340.69 (31.2%)	640.55 (8.5%)	2981.24 (39.7%)
TOTALS	4681.38 (62.4%)	1281.09 (17.1%)	5962.47 (79.5%)

PHOTOMETRICS FOR 100 WATT GARAGE LIGHTER

ISOFOOTCANDLE LINES OF HORIZONTAL ILLUMINATION VALUES BASED ON 20.00 FOOT MOUNTING HEIGHT

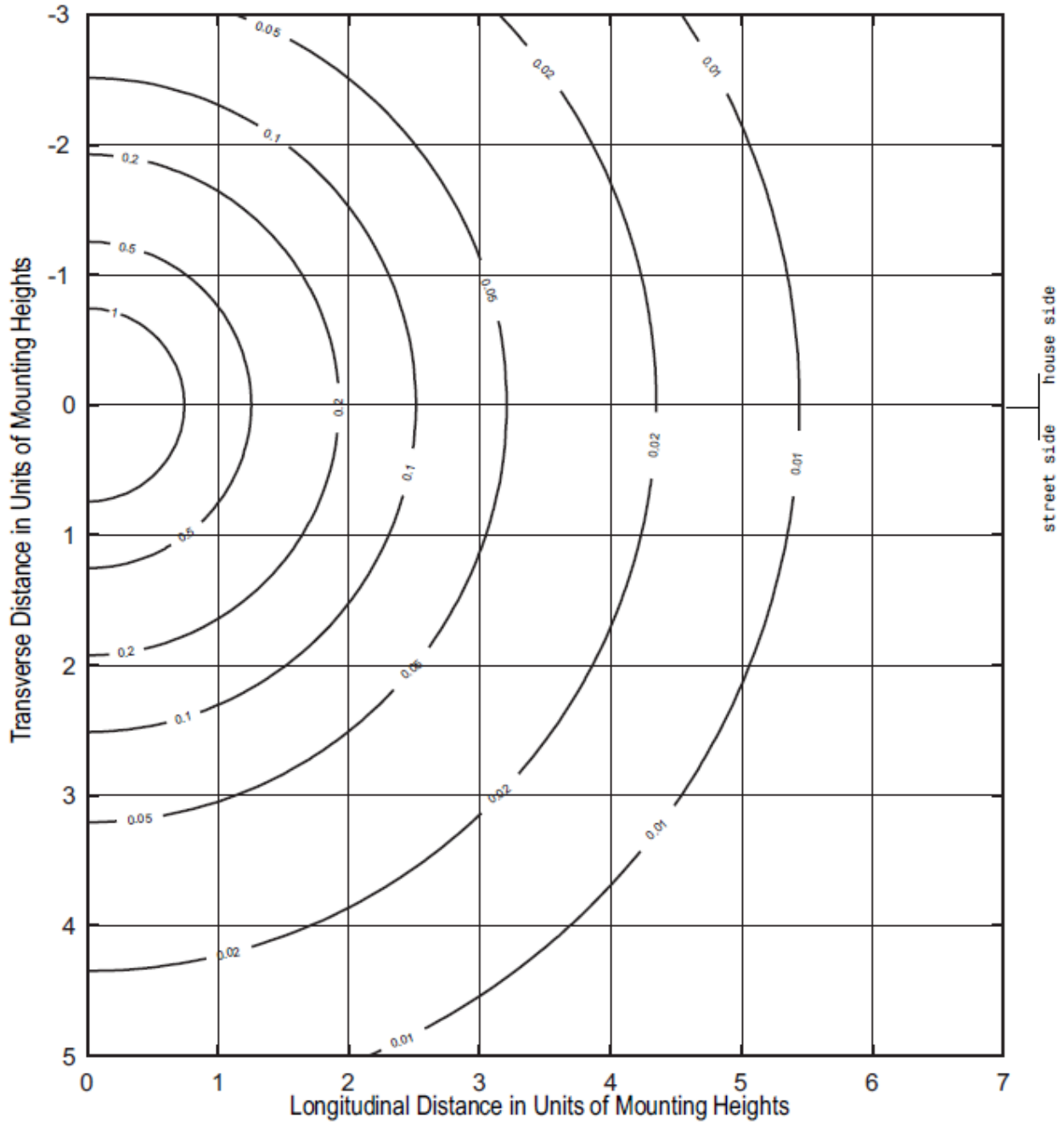

PHOTOMETRICS FOR 100 WATT GARAGE LIGHTER

MAXIMUM PLANE AND CONE PLOTS OF CANDELA

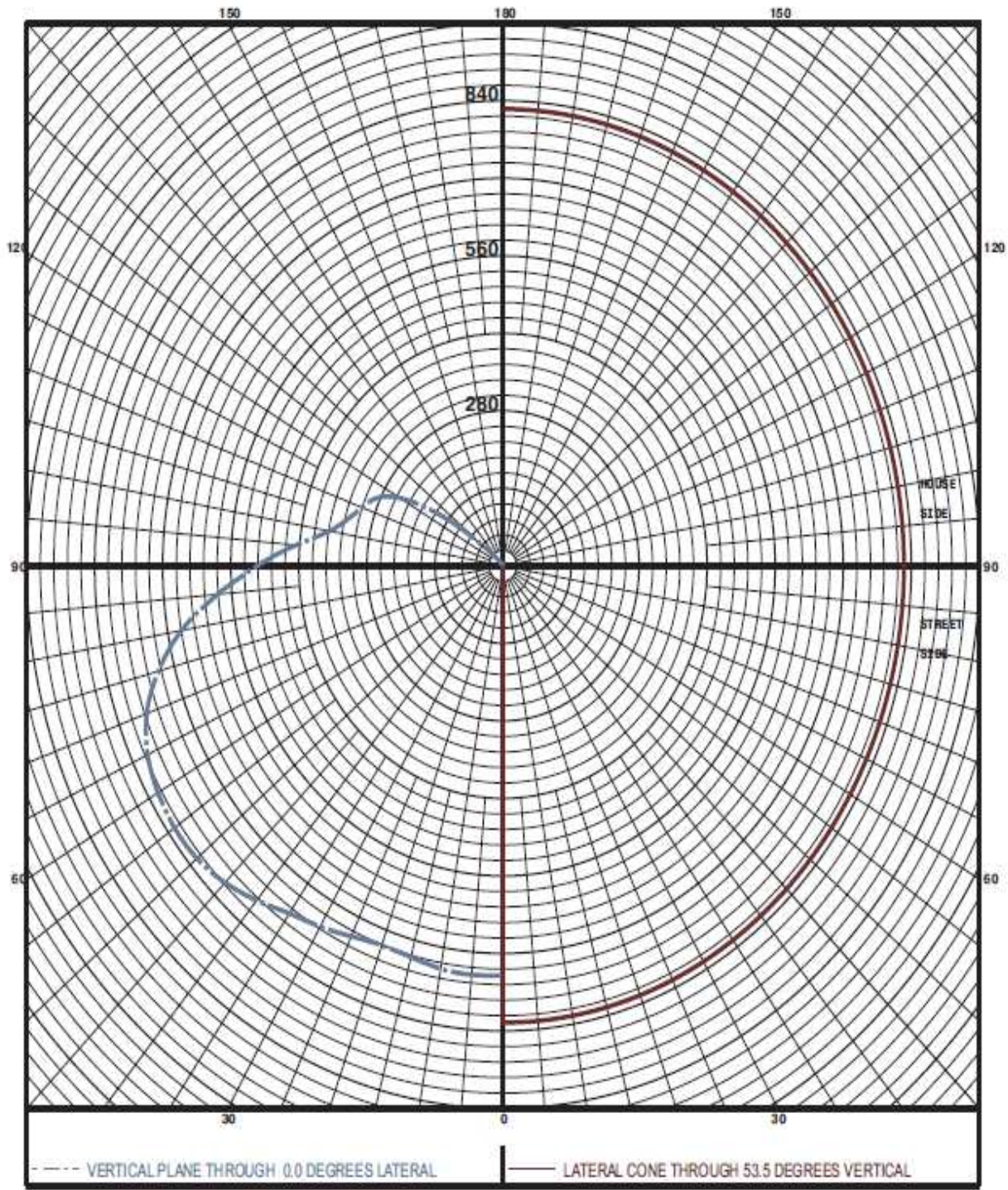

PHOTOMETRICS FOR 100 WATT GARAGE LIGHTER

FLUX DISTRIBUTION TABLE BASED ON THE IESNA LUMINAIRE CLASSIFICATION SYSTEM
FLUX

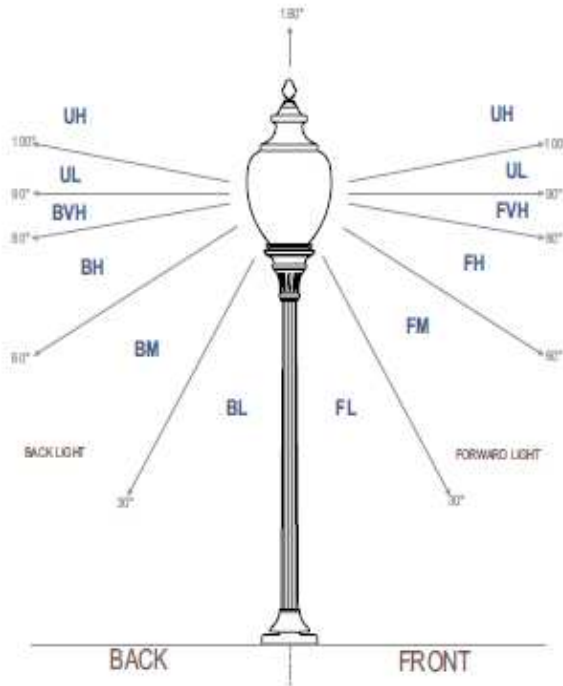

ZONE	LUMINAIRE LUMENS	% OF LAMP LUMENS
FORWARD LIGHT	2341	31.2
FL (0°-30°)	310	4.1
FM (30°-60°)	924	12.3
FH (60°-80°)	786	10.5
FVH (80°-90°)	321	4.3
BACK LIGHT	2341	31.2
BL (0°-30°)	310	4.1
BM (30°-60°)	924	12.3
BH (60°-80°)	786	10.5
BVH (80°-90°)	321	4.3
UPLIGHT	1281	17.1
UL (90°-100°)	469	6.3
UH (100°-180°)	812	10.8
TRAPPED LIGHT	1538	20.5

